

5KHB3583



KitchenAid

TABLE OF CONTENTS

- HAND BLENDER SAFETY**
 - Important safeguards 6
 - Electrical requirements 7
 - Electrical equipment waste disposal 7
 - Disposing of KitchenAid Lithium-Ion (Li-Ion) battery 7
- PARTS AND FEATURES**
 - Parts and features 8
- OPERATING THE HAND BLENDER**
 - Before first use: charging the battery 9
 - Assembling the Hand Blender 10
 - Using the LED display panel 11
 - Using the blending arm 12
- TIPS FOR GREAT RESULTS**
 - Techniques for better blending and crushing 13
 - Operating tips 13
- CARE AND CLEANING**
 - Cleaning the Hand Blender 14
- SERVICE AND WARRANTY**
 - KitchenAid Hand Blender warranty 15
 - Customer service 15

HAND BLENDER SAFETY

Your safety and the safety of others are very important.

We have provided many important safety messages in this manual and on your appliance. Always read and obey all safety messages.



This is the safety alert symbol.

This symbol alerts you to potential hazards that can kill or hurt you and others.

All safety messages will follow the safety alert symbol and either the word “DANGER” or “WARNING.” These words mean:

 **DANGER**

You can be killed or seriously injured if you don't immediately follow instructions.

 **WARNING**

You can be killed or seriously injured if you don't follow instructions.

All safety messages will tell you what the potential hazard is, tell you how to reduce the chance of injury, and tell you what can happen if the instructions are not followed.

IMPORTANT SAFEGUARDS

When using electrical appliances, basic safety precautions should always be followed, including the following:

1. Read all instructions.
2. To protect against risk of electrical shock, do not put motor body of Hand Blender, battery, charger, charger's cord or plug in water or other liquid.
3. This appliance is not intended for use by persons (including children) with reduced physical sensory or mental capabilities, or lack of experience and knowledge, unless they have been given supervision or instruction concerning use of the appliance by a person responsible for their safety.
4. Children should be supervised to ensure that they do not play with the appliance.
5. Avoid contact with moving parts.
6. Do not operate any appliance or charger with a damaged cord, or plug, or after the appliance or charger malfunctions, or is dropped, or damaged in any manner. Return appliance or charger to the nearest Authorized Service Facility for examination, repair, or electrical or mechanical adjustment.
7. The use of attachments not recommended or sold by KitchenAid may cause fire, electric shock, or injury.
8. Do not let power cord on charger hang over edge of table or counter. Excess cord may be wrapped on the underside of the charger.
9. Do not let power cord on charger contact hot surfaces, including the stove.
10. When mixing liquids, especially hot liquids, use a tall container, or make small quantities at a time to reduce spillage.
11. Keep hands and utensils out of the container while blending to prevent the possibility of severe injury to persons, or damage to the unit. A scraper may be used, but must be used only when the unit is not running.
12. Blades are sharp. Handle carefully.
13. Always remove the battery from the Hand Blender if it is left unattended and before assembling, disassembling or cleaning.
14. This product is designed for household use only.

SAVE THESE INSTRUCTIONS

Electrical requirements

Battery Voltage: 12 V Lithium-Ion (Li-ion) / 1.5 Ah / 16 Wh

Battery Model No.: 5KCL12IBOB

Charger

Input : 18 V / 660 mA

Output : 12 V / 550 mA

Charger Model No.: 5KCL12CSOB

Charger Adapter

Input : 220-240 V / 50/60 Hz / 18 W

Output : 18 V / 660 mA

Charger Adapter Model No.: W10533411

Electrical equipment waste disposal

This appliance is marked according to the European directive 2002/96/EC on Waste Electrical and Electronic Equipment (WEEE).

By ensuring this product is disposed of correctly, you will help avoid potential negative consequences for the environment and human health, which could otherwise be caused by inappropriate waste handling of this product.

The symbol  on the product, or on the documents accompanying the product, indicates that this appliance may not be

treated as household waste. Instead it shall be handed over to the applicable collection point for the recycling of electrical and electronic equipment.

Disposal must be carried out in accordance with local environmental regulations for waste disposal.

For more detailed information about treatment, recovery, and recycling of this product, please contact your local city office, your household waste disposal service, or the shop where you purchased the product.

Disposing of KitchenAid Lithium-Ion (Li-Ion) battery

Always dispose of your battery according to local regulations. Contact a recycling agency in your area for recycling locations.

Even discharged batteries contain some energy. Before disposing, use electrical tape to cover the terminals to prevent the battery from shorting, which could cause a fire or explosion.

PARTS AND FEATURES

Parts and features

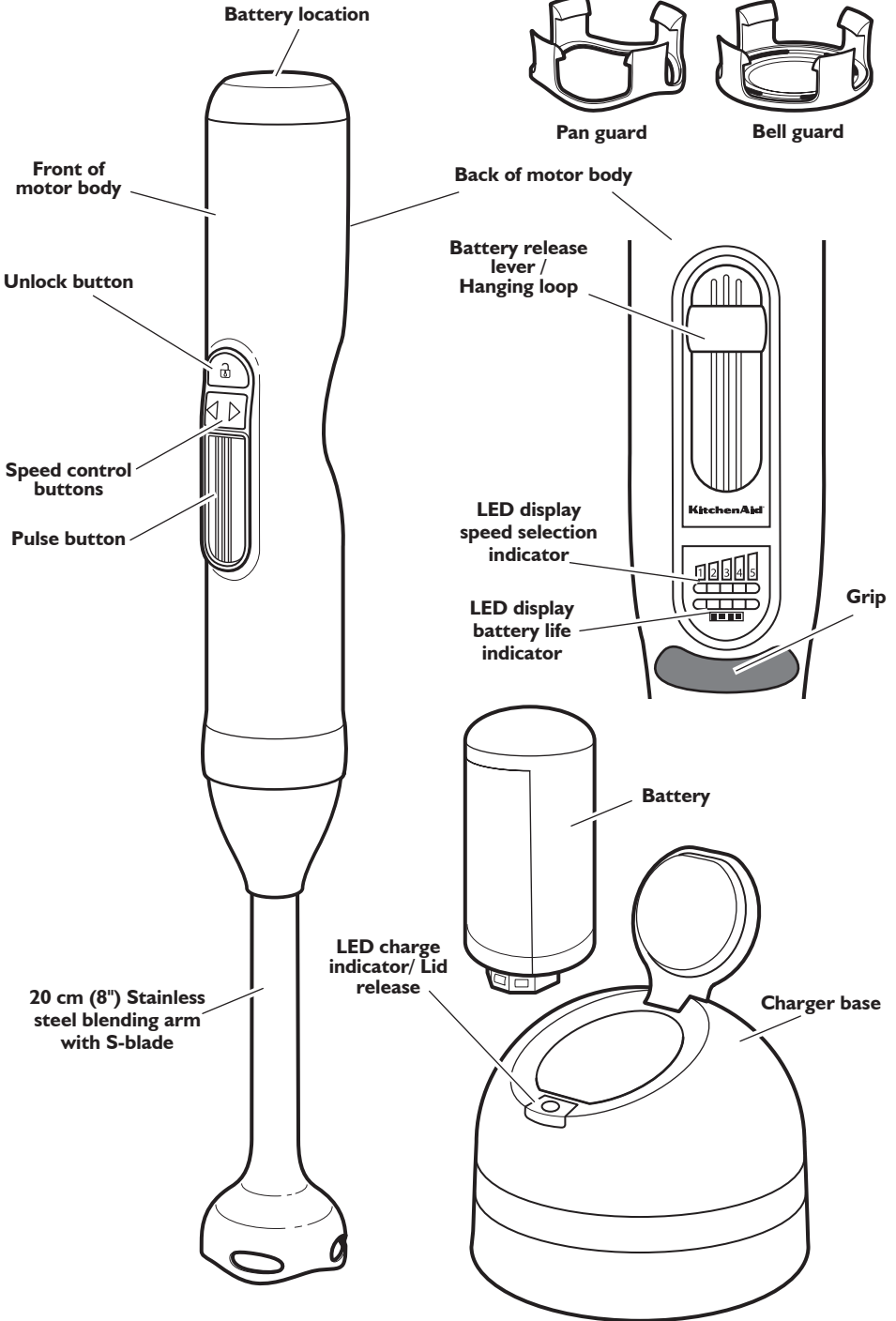

OPERATING THE HAND BLENDER

Before first use: charging the battery

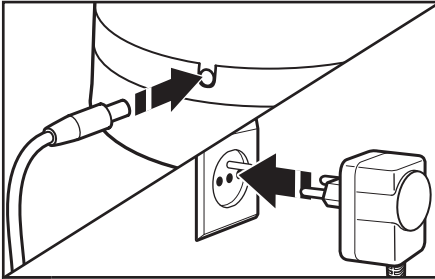

1 Plug in the charger.

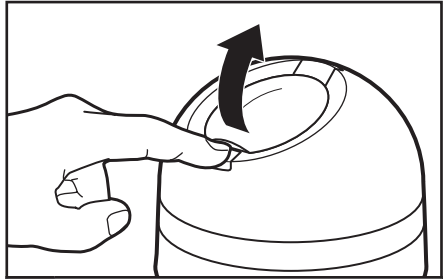

2 Push the lid release button to open the lid.

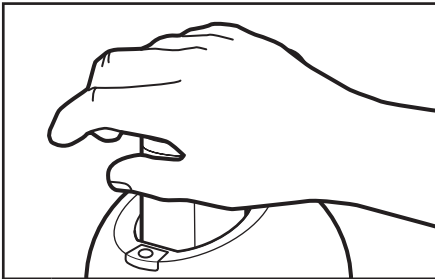

3 Slide the battery into the charger, aligning the flat side of the battery to the flat side of the port, and push down to click into place.

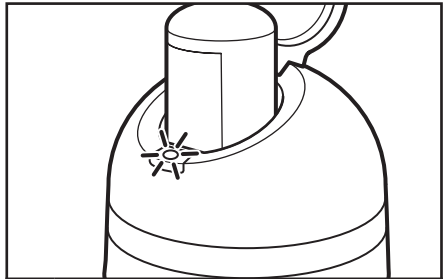

4 The LED indicator will begin to flash slowly and continuously as it charges. When the battery is fully charged, the LED will display a continuous light.

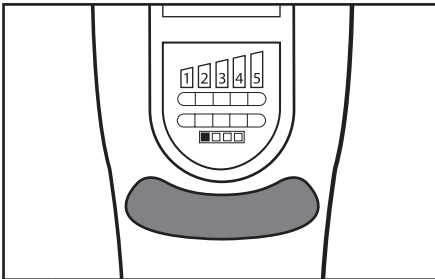

5 Charge the battery after each use, when the battery indicator lights show less than 25% battery life remaining (only one light displays on the LED battery life indicator), or when the battery is completely drained.

NOTE: If the charger quickly flashes three times after inserting the battery, there is a battery error. Check that the battery is placed properly in the charger. If the light continues to flash rapidly, the battery may be extremely cold, hot, wet or damaged. Allow the battery to cool down, warm up or dry out, then reinsert. If the problem persists, see the “Service and Warranty” section.

NOTE: Batteries do not develop a “memory” when charged after only a partial discharge. It is not necessary to run down the battery before placing it on the charger.

OPERATING THE HAND BLENDER

Assembling the Hand Blender

! WARNING

Cut Hazard

Handle blades carefully.

Failure to do so can result in cuts.

Before First Use

Before using the Hand Blender for the first time, wipe the motor body, the blending arm with blade and the guards with a clean, damp cloth to remove any dirt or dust. Mild dish soap may be used. Do not use abrasive cleansers. Dry thoroughly with a soft cloth. See “Care and Cleaning” section for more information.

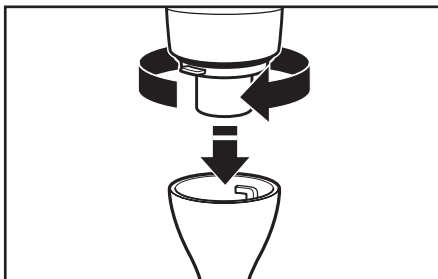

- 1** Insert blending arm into motor body and twist until it clicks to lock in place.

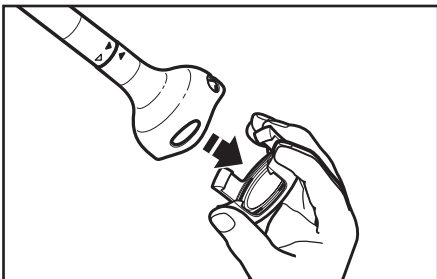

- 2** Remove the bell guard from the blade.

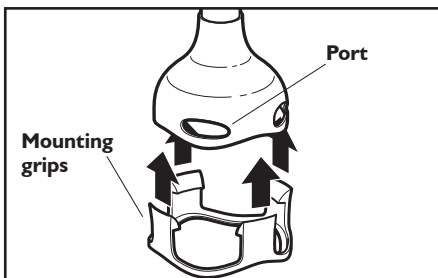

- 3** If using a pan guard, place it on a flat surface and position with mounting clips between the ports of the blade.

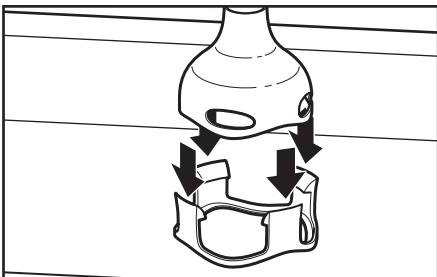

- 4** Snap pan guard into place with an even, downward motion.



Bell guard

NOTE: Use the **bell guard** to avoid damage to blade when Hand Blender is not in use.



Pan guard

Use the **pan guard** to avoid damage to cookware while using Hand Blender.

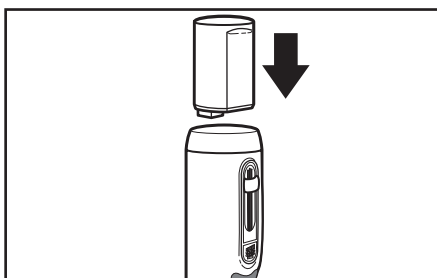

- 5** Slide the charged battery into the top of the Hand Blender motor body. Make sure it latches securely.

OPERATING THE HAND BLENDER

Using the LED display panel

IMPORTANT: The unlock button must be pressed before the Hand Blender will operate.

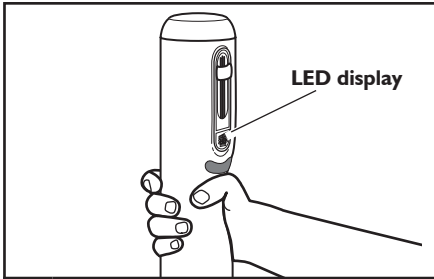

- 1 When operating the controls on the Hand Blender, always make sure the LED display is facing toward you. Grip the handle with your thumb on the back of the unit, and your fingers on the controls in front, as shown.

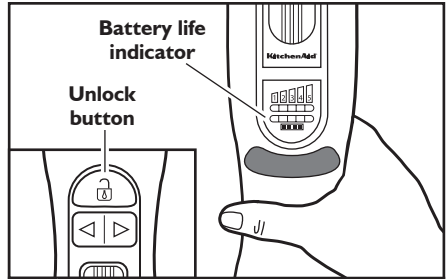

- 2 The bottom bar on the LED display panel is the battery life indicator. Hold the Hand Blender so that you can see the LED display light up when you press the UNLOCK button with your index finger.

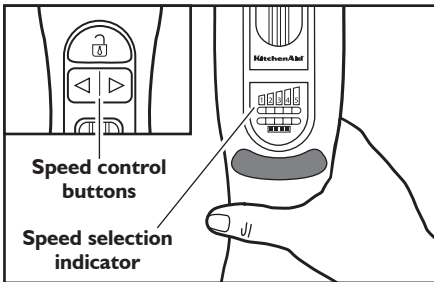

- 3 The top bar on the LED display panel is the speed selection indicator. To adjust speeds, operate the arrow buttons with your index finger, while viewing the speed indicator on the LED display. When the LED faces you, the right button will increase the speed and the left button will decrease the speed.

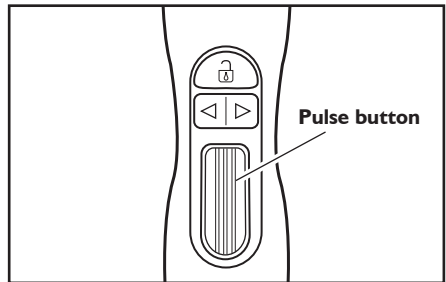

- 4 After selecting desired speed, press the PULSE button to begin blending. See “Using the blending arm” section for more information.

NOTE: The Hand Blender will automatically power down after 60 seconds of not operating or being manually unlocked.

OPERATING THE HAND BLENDER

Using the blending arm

NOTE: Your Hand Blender is ideal to use for blending, crushing, or puréeing. It is best used for soups, cooked vegetables, sauces, baby food, smoothies, milk shakes, frosting, or crushed ice.

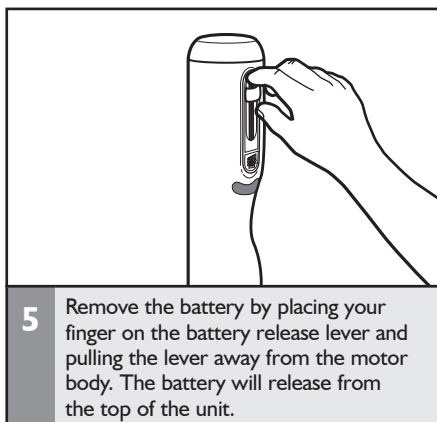
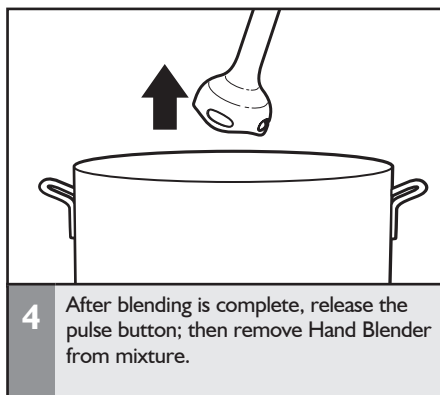
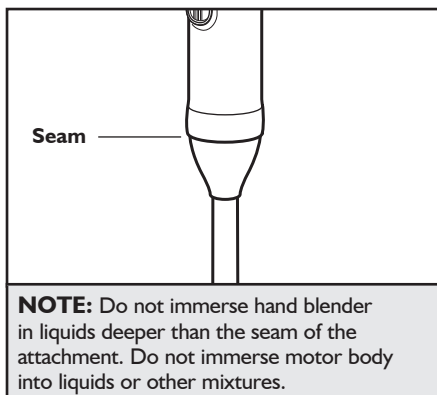
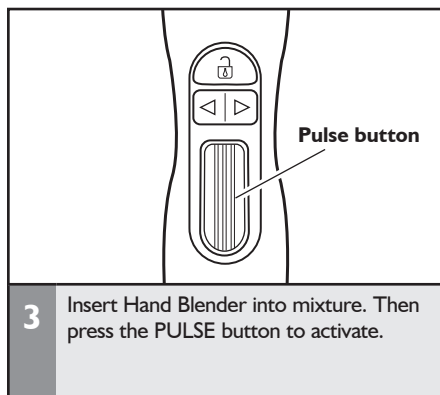
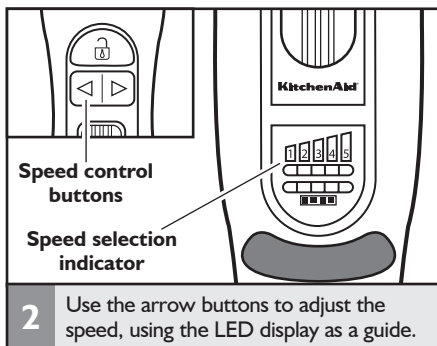
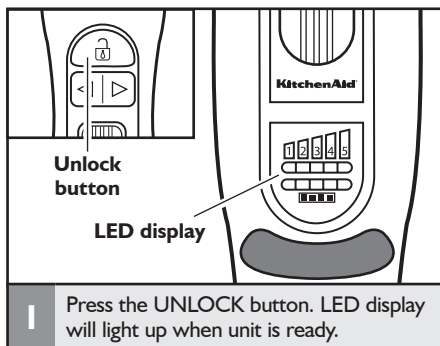

TIP: To avoid splashing, insert the Hand Blender into the mixture before pressing the pulse button, and release the pulse button before pulling the Hand Blender out of the mixture.

IMPORTANT: Always wait to insert battery into Hand Blender until accessories are attached. After using, always remove battery before disassembling Hand Blender.

TIPS FOR GREAT RESULTS

Techniques for better blending and crushing

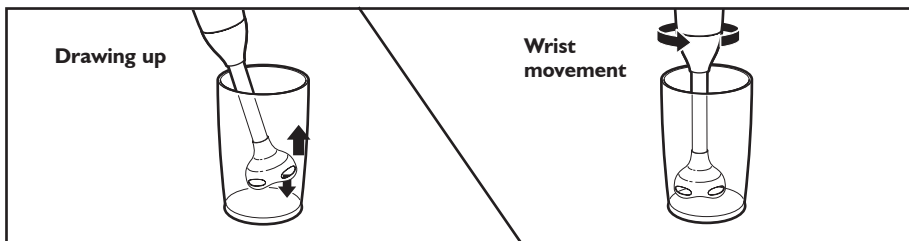

For better blending: Rest the Hand Blender on the bottom of the container momentarily, then hold at an angle and using a light circular motion, slowly draw it upwards against the side of the container. Allow your wrist motion and the weight of the Hand Blender to do the work. As you draw up the Hand Blender, you will notice the ingredients from the bottom of the container rising up. When the ingredients are no longer rising from the bottom, return the Hand Blender to the bottom of the container and repeat until mixture is at the desired consistency.

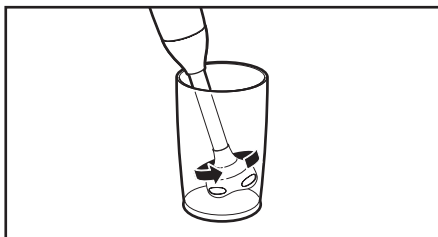

For better crushing: Insert Hand Blender with blending arm attached into the container. For hard, frozen fruits or ice, add a small amount of liquid until the S-blade is submerged. Remember to stop the Hand Blender before removing it from the container to avoid splashing.

TIP: To prevent overflow, allow room in the container for the mixture to rise when blending.

Operating tips

- Do not let the Hand Blender sit in a hot pan on the cooktop when not in use.
- The Hand Blender is equipped with thermal protection from high operating temperatures. Should the Hand Blender suddenly stop during use, press the UNLOCK button once, then press the PULSE button. If the unit does not operate, but shows information on the battery indicator bar, allow 10 minutes to automatically reset. If the unit does not display information on the battery indicator bar, charge the battery. If the battery is already fully charged, and the unit fails to operate, see the “Service and Warranty” section.
- When blending in a saucepan on a cooktop, remove the pan from the heating element to protect the Hand Blender from overheating.
- Cut solid foods into small pieces for easier blending.
- Do not use Hand Blender to process coffee beans or hard spices such as nutmeg. Processing these foods may damage the blades.

CARE AND CLEANING

Cleaning the Hand Blender

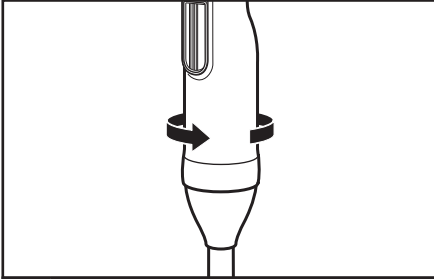

- 1 Remove blending arm (see “Operating the Hand Blender” section).

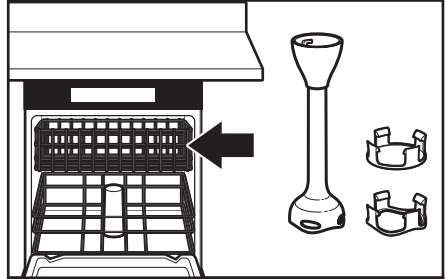

- 2 Wash blending arm and guards in the top rack of the dishwasher or by hand in hot, soapy water. Dry with a soft cloth.

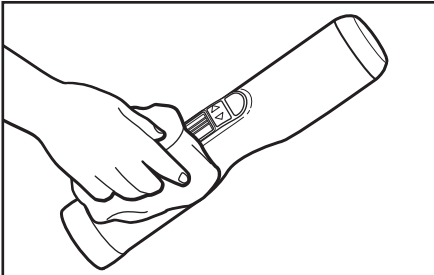

- 3 Wipe the motor body with a damp cloth. Use mild dish soap. Do not use abrasive cleansers.

NOTE: Always remove the battery from the Hand Blender if it is left unattended and before assembling, disassembling or cleaning.

Do not immerse motor body in water.

SERVICE AND WARRANTY

KitchenAid Hand Blender warranty

English

| Length of Warranty: | KitchenAid Will Pay For: | KitchenAid Will Not Pay For: |
|---|---|--|
| Europe, Middle East and Africa: For Model 5KHB3583: Three years Full Warranty from date of purchase. | The replacement parts and repair labor costs to correct defects in materials or workmanship. Service must be provided by an Authorized KitchenAid Service Center. | A. Repairs when Hand Blender is used for operations other than normal household food preparation. B. Damage resulting from accident, alterations, misuse, abuse, or installation/operation not in accordance with local electrical codes. |

KITCHENAID DOES NOT ASSUME ANY RESPONSIBILITY FOR INDIRECT DAMAGES.

Customer service

In U.K. and Ireland:

For any questions, or to find the nearest KitchenAid Authorized Service Center, please find our contact details below.

NOTE: All service should be handled locally by an Authorized KitchenAid Service Center.

Contact number for U.K. and Northern Ireland:

Tollfree number 0800 988 1266 (calls from mobile phones are charged standard network rate)

Contact number for Ireland:

Tollfree number +44 (0) 20 8616 5148

E-mail contact for U.K. and Ireland:

Go to www.kitchenaid.co.uk, and click on the link "Contact Us" at the bottom of the page.

Address for U.K. and Ireland:

KitchenAid Europa, Inc.
PO BOX 19
B-2018 ANTWERP 11
BELGIUM

In other countries:

For all product related questions and after sales matters, please contact your dealer to obtain the name of the nearest Authorized KitchenAid Service/Customer Center.

www.KitchenAid.eu

KitchenAid

© 2013. All rights reserved.
Specifications subject to change without notice.